

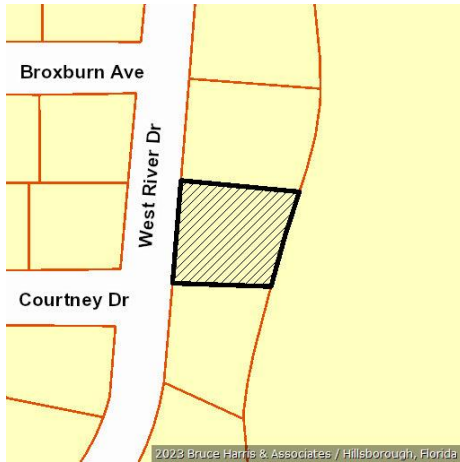

Bob Henriquez Hillsborough County Property Appraiser

https://www.hcpafl.org/
15th Floor County Ctr.
601 E. Kennedy Blvd, Tampa, Florida 33602-4932
Ph: (813) 272-6100

Folio: 202780-0142



Owner Information

Owner Name	TOUMBEVA TATIANA H
Mailing Address	1093 FOGGY BROOK PLACE LONGWOOD, FL 32750-
Site Address	1119 WEST RIVER DR, TEMPLE TERRACE
PIN	T-26-28-19-56B-000012-00021.0
Folio	202780-0142
Prior PIN	
Prior Folio	202625-0000
Tax District	TT - TEMPLE TERRACE
Property Use	0000 VACANT RESIDENTIAL
Plat Book/Page	52/9
Neighborhood	217001.00 26-28-19 S of Riverhills Dr, River Bdry
Subdivision	56B REPLAT OF A PORTION OF BLOCK 12 OF TEMPLE TER

Value Summary

Taxing District	Market Value	Assessed Value	Exemptions	Taxable Value
County	\$18,554	\$14,967	\$0	\$14,967
Public Schools	\$18,554	\$18,554	\$0	\$18,554
Municipal	\$18,554	\$14,967	\$0	\$14,967
Other Districts	\$18,554	\$14,967	\$0	\$14,967

Note: This section shows Market Value, Assessed Value, Exemptions, and Taxable Value for taxing districts. Because of changes in Florida Law, it is possible to have different assessed and taxable values on the same property. For example, the additional \$25,000 Homestead Exemption and the non-homestead CAP do not apply to public schools, and the Low Income Senior Exemption only applies to countywide and certain municipal millages.

Sales Information

Book / Page	Instrument	Month	Year	Type Inst	Qualified or Unqualified	Vacant or Improved	Price
	2023259273	06	2023	WD	Unqualified	Vacant	\$200,000
	2022540209	04	2019	QC	Unqualified	Vacant	\$100
18548 / 1582	2008120827	03	2008	WD	Unqualified	Vacant	\$50,000
15044 / 1761	2005224279	05	2005	WD	Unqualified	Vacant	\$50,000
12778 / 1789	2003251469	06	2003	WD	Unqualified	Vacant	\$100
12751 / 1964	2003239533	06	2003	CT	Unqualified	Vacant	\$235,000
11026 / 1539	2001274592	08	2001	WD	Unqualified	Vacant	\$250,000
3259 / 0184		07	1977	WD	Unqualified	Vacant	\$100

Land Information

Use Code	Description	Zone	Front	Depth	Land Type	Total Land Units	Land Value
05HP	Hillsborough River Class 14	R-10	114.00	92.00	FF FRONT FEET	114.00	\$18,554

Legal Description

REPLAT OF A PORTION OF BLOCK 12 OF TEMPLE TERRACE RIVERSIDE SUBDIVISION UNIT NO 2 LOT 21 BLOCK 12